

## G ELECTRICAL WIRING ROUTING

□ : Location of Connector Joining Wire Harness and Wire Harness

▽ : Location of Ground Points

[1MZ-FE]

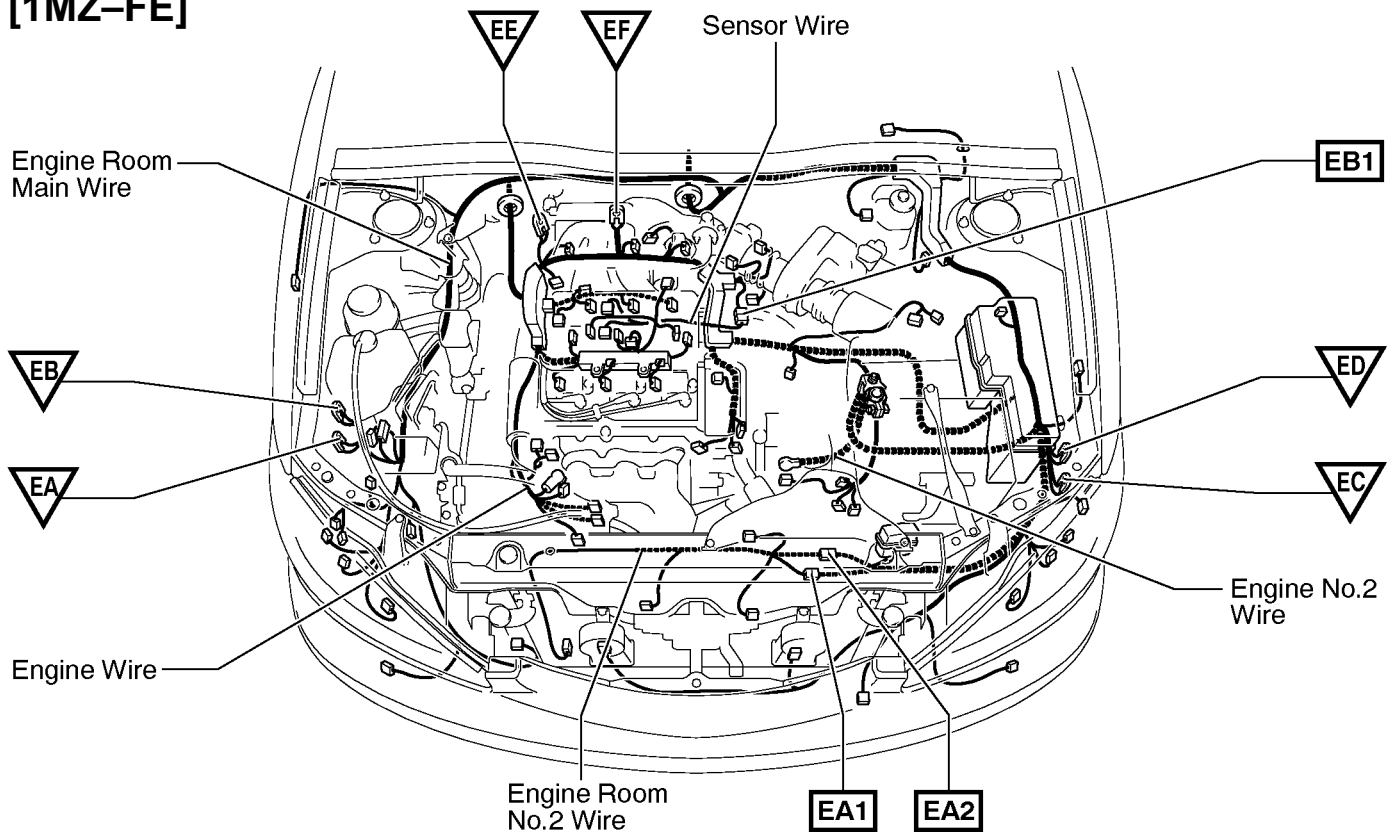

○ : Location of Splice Points

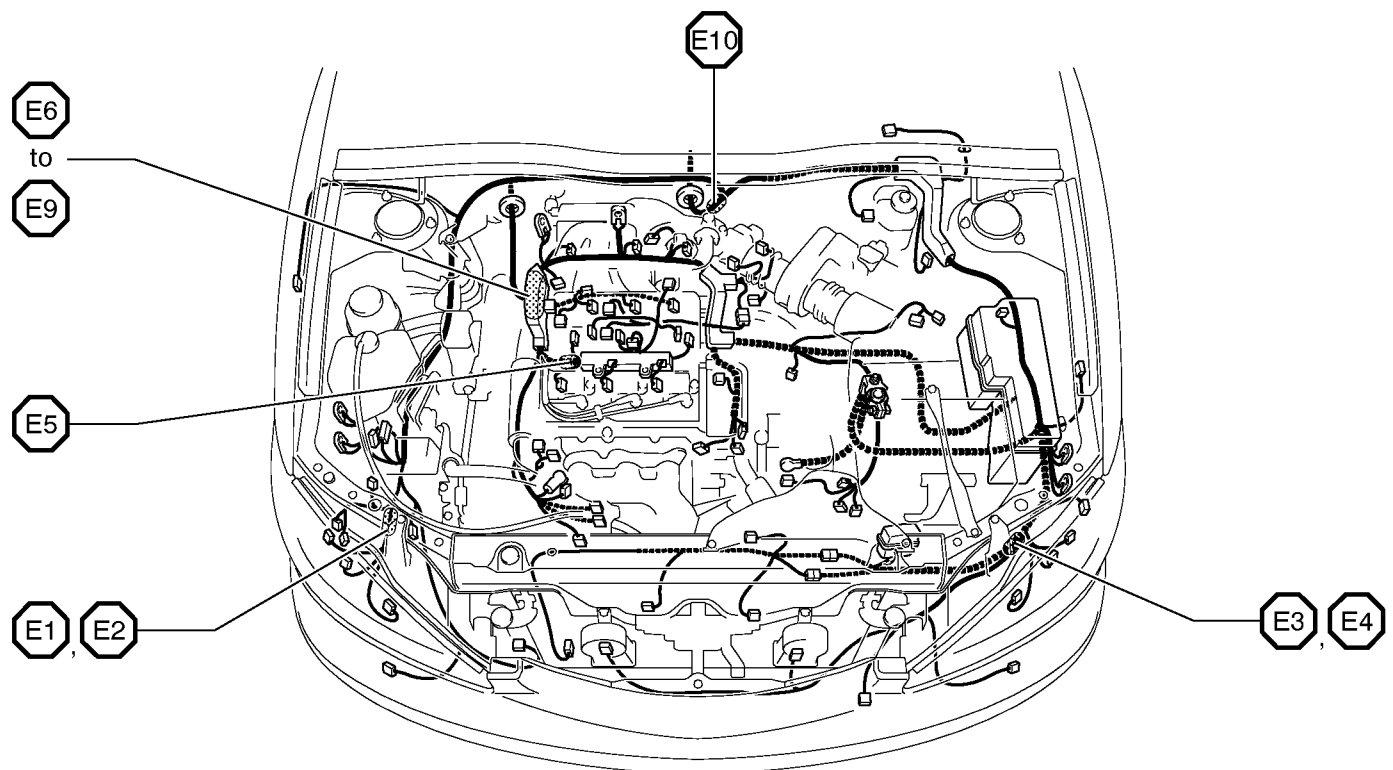

## Connector Joining Wire Harness and Wire Harness

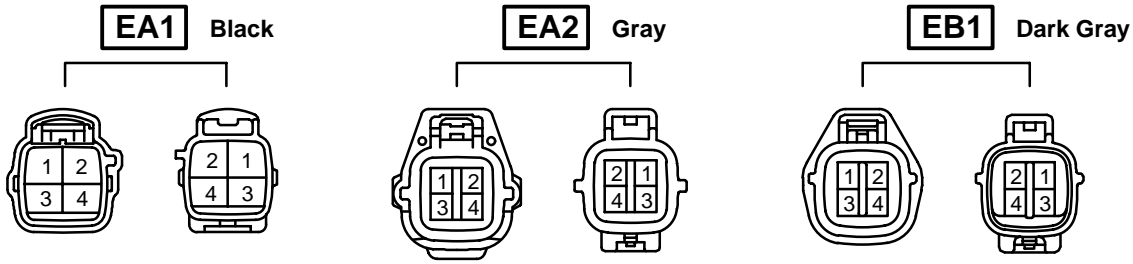

Code	Joining Wire Harness and Wire Harness (Connector Location)
EA1	Engine Room Main Wire and Engine Room No.2 Wire (Radiator Side Supprot LH)
EA2	
EB1	Engine Wire and Sensor Wire (Left Back of Cylinder Head)

## G ELECTRICAL WIRING ROUTING

□ : Location of Connector Joining Wire Harness and Wire Harness

▽ : Location of Ground Points

[2AZ-FE]

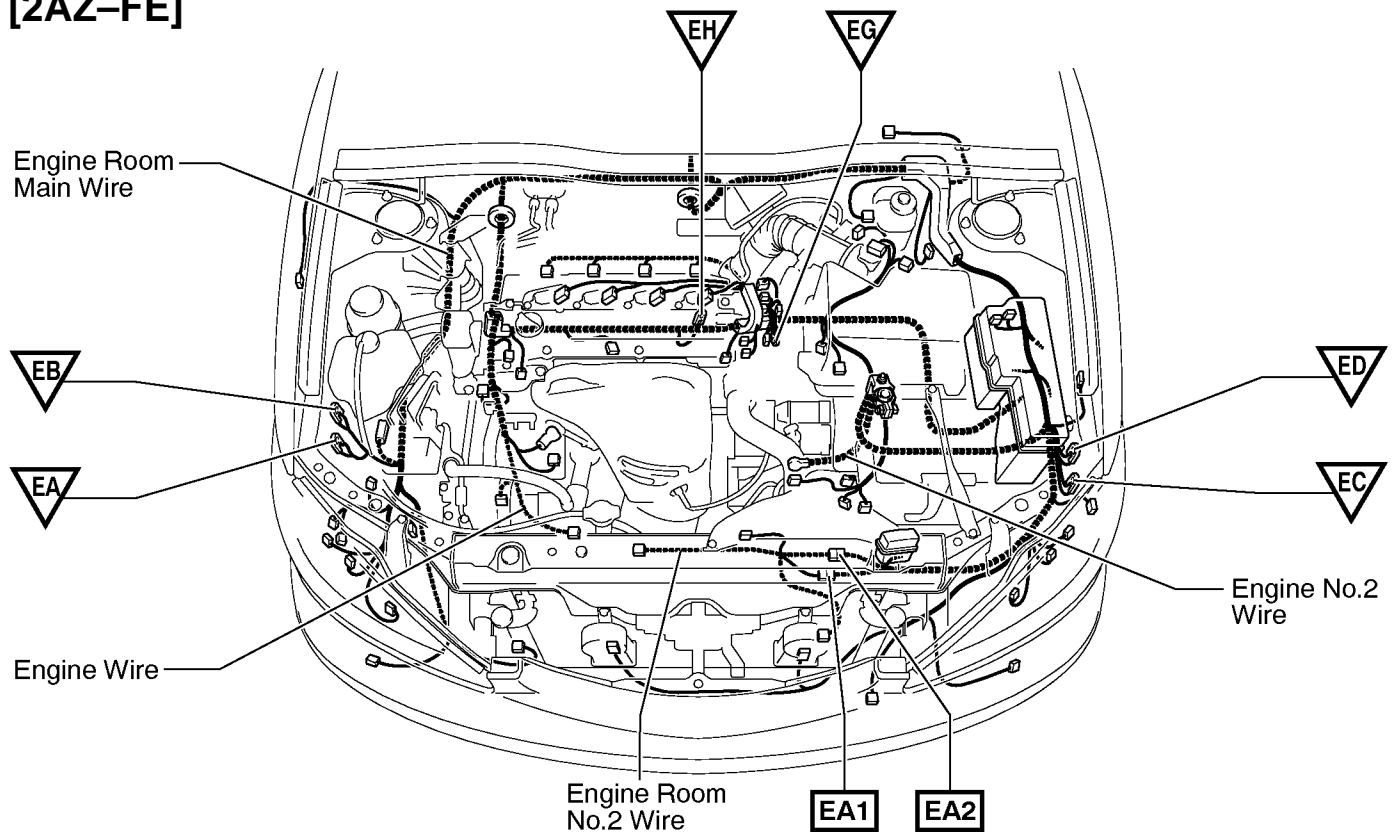

○ : Location of Splice Points

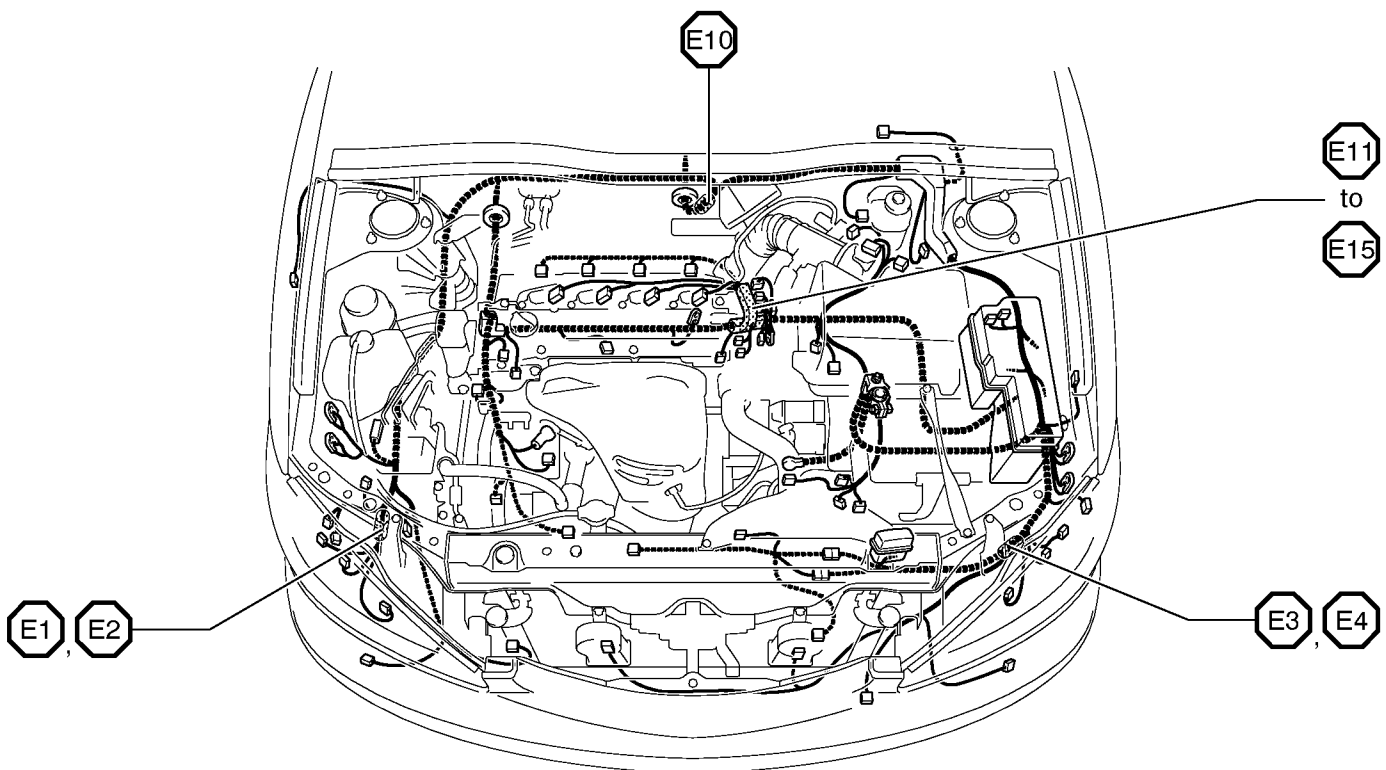

# Connector Joining Wire Harness and Wire Harness

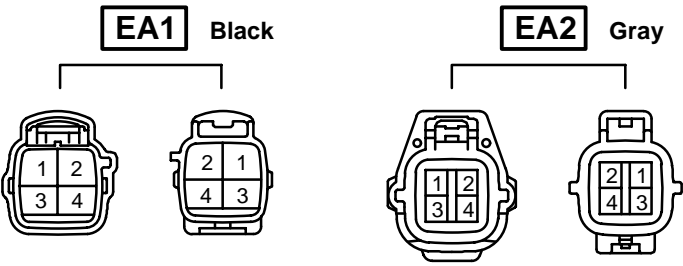

Code	Joining Wire Harness and Wire Harness (Connector Location)
EA1	Engine Room Main Wire and Engine Room No.2 Wire (Radiator Side Support LH)
EA2	

## G ELECTRICAL WIRING ROUTING

□ : Location of Connector Joining Wire Harness and Wire Harness

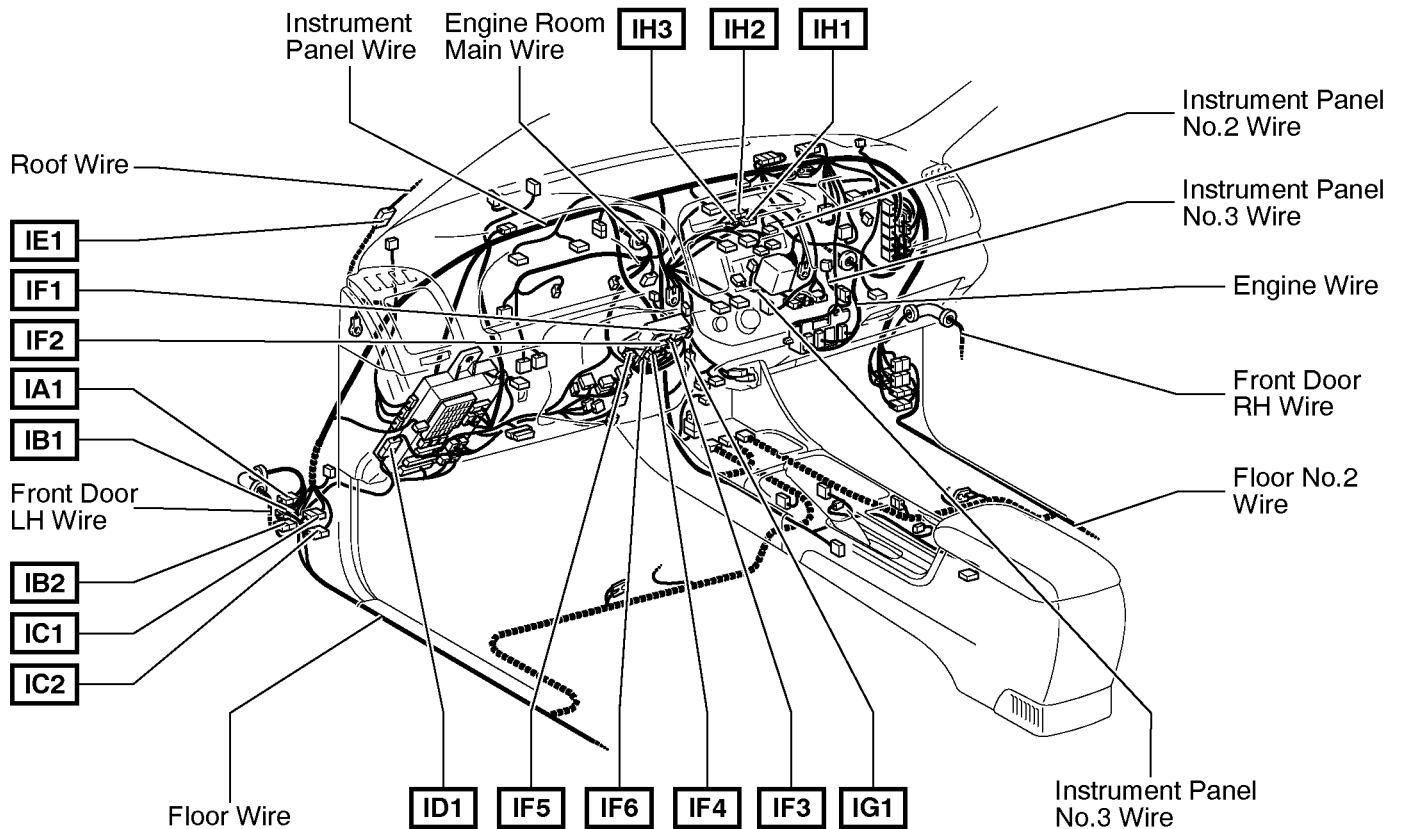

▽ : Location of Ground Points

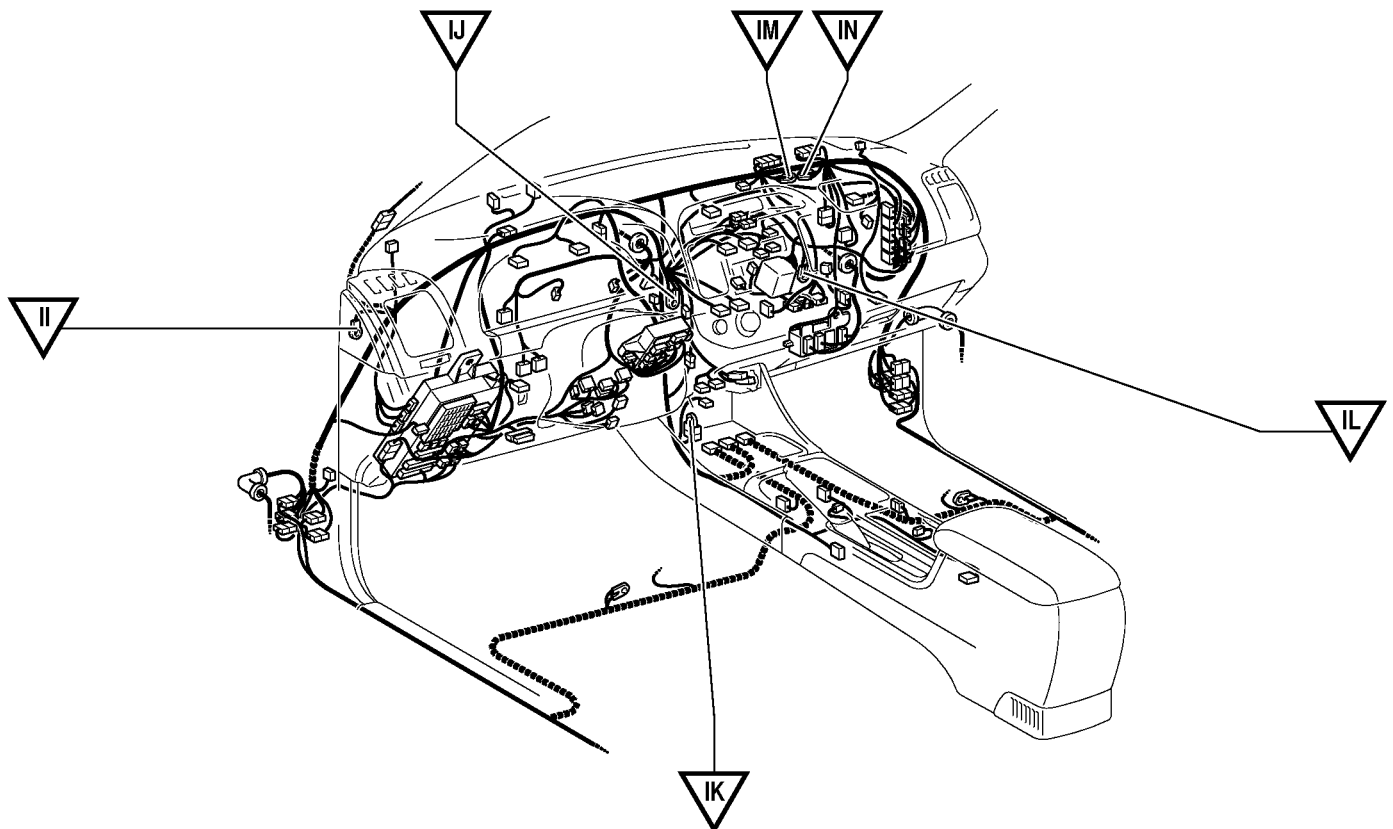

## Connector Joining Wire Harness and Wire Harness

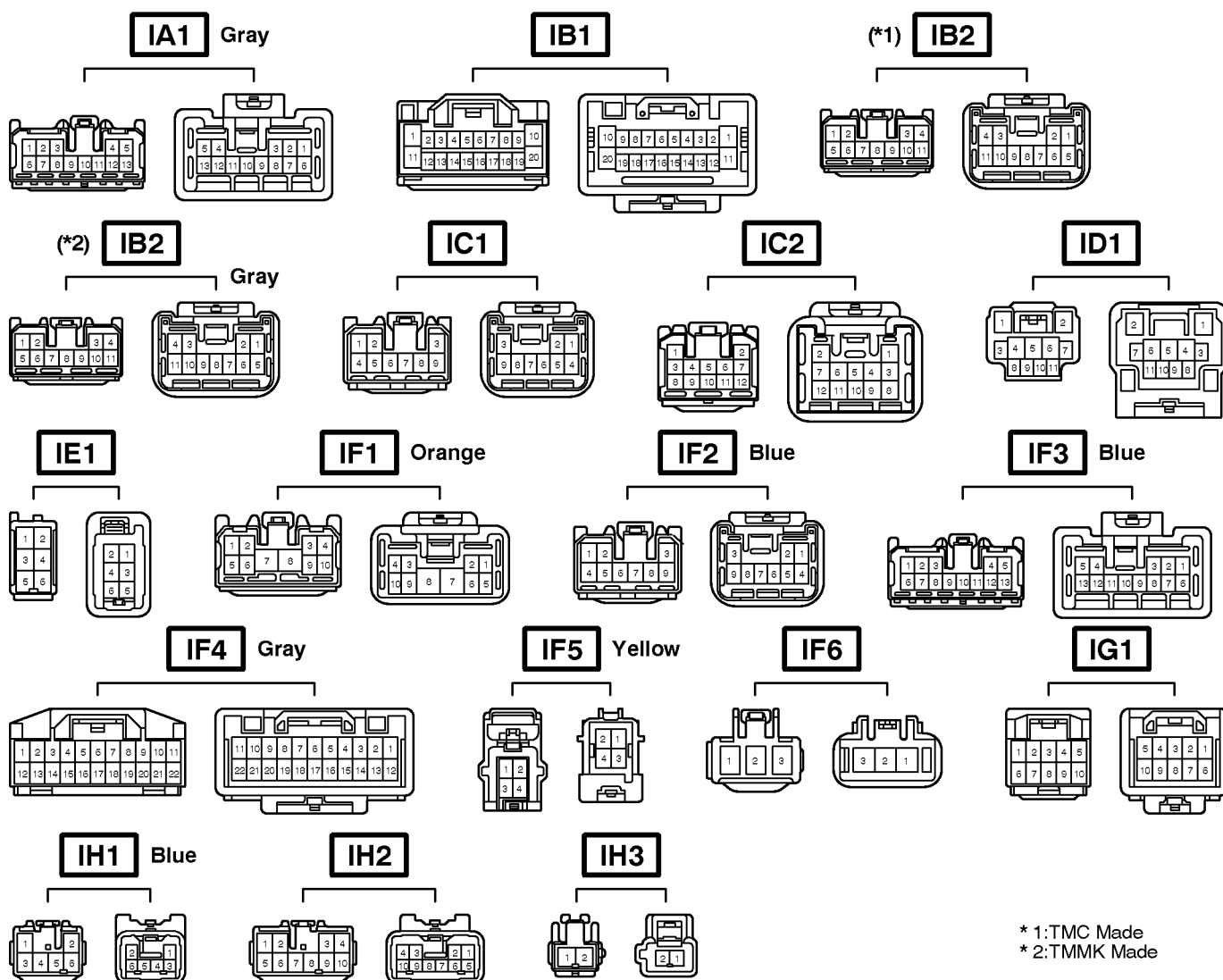

\* 1:TMC Made  
\* 2:TMMK Made

Code	Joining Wire Harness and Wire Harness (Connector Location)
IA1	Front Door LH Wire and Floor Wire (Left Kick Panel)
IB1	Front Door LH Wire and Instrument Panel Wire (Left Kick Panel)
IB2	
IC1	Instrument Panel Wire and Floor Wire (Left Kick Panel)
IC2	
ID1	Engine Room Main Wire and Floor Wire (Left Side of Driver Side J/B)
IE1	Instrument Panel Wire and Roof Wire (Inside of Front Left Pillar)
IF1	Engine Room Main Wire and Instrument Panel Wire (Right Side of Steering Column Tube)
IF2	
IF3	
IF4	
IF5	
IF6	
IG1	Instrument Panel Wire and Engine Room Main Wire (Instrument Panel Brace LH)
IH1	Instrument Panel Wire and Instrument Panel No.2 Wire (Instrument Panel Brace RH)
IH2	
IH3	

## G ELECTRICAL WIRING ROUTING

□ : Location of Connector Joining Wire Harness and Wire Harness

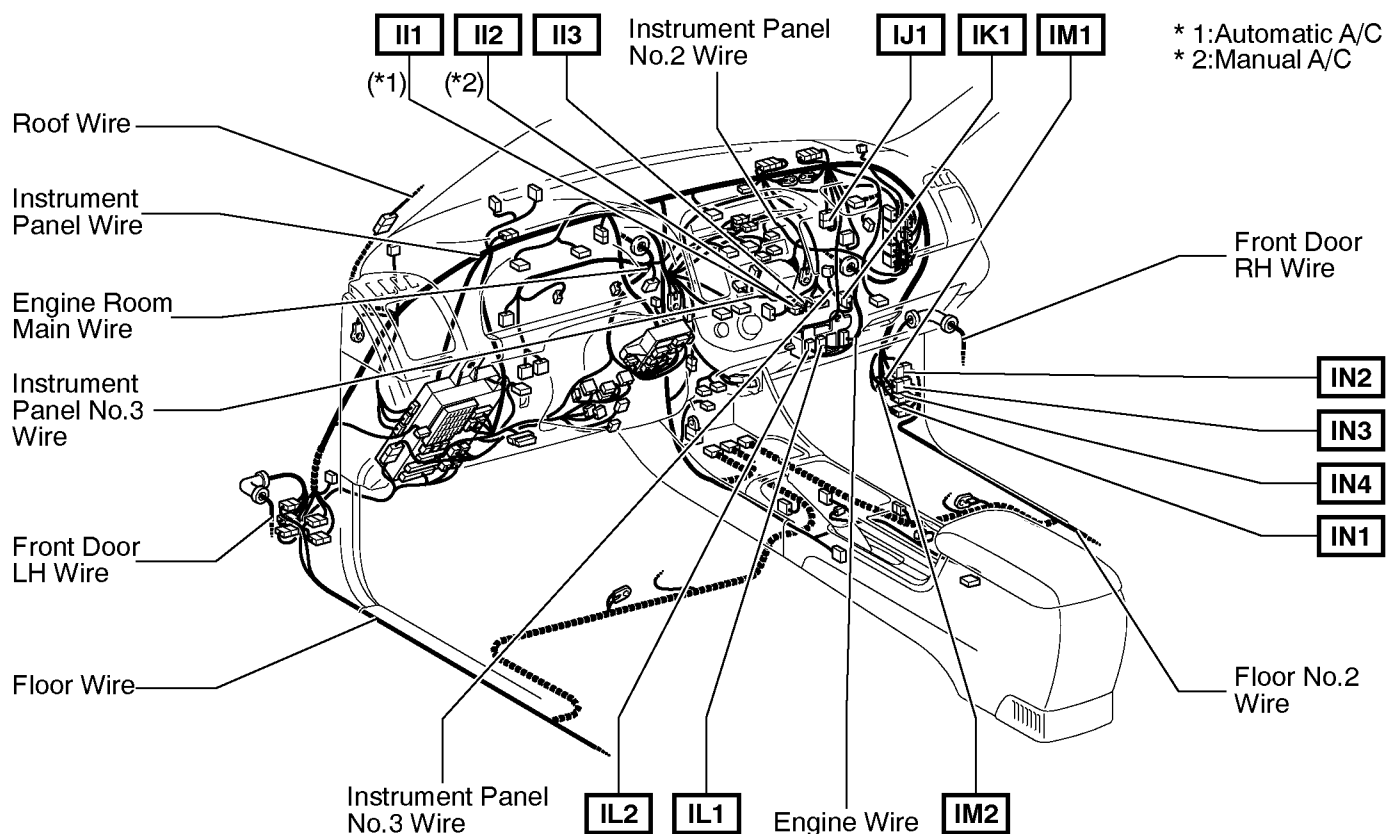

○ : Location of Splice Points

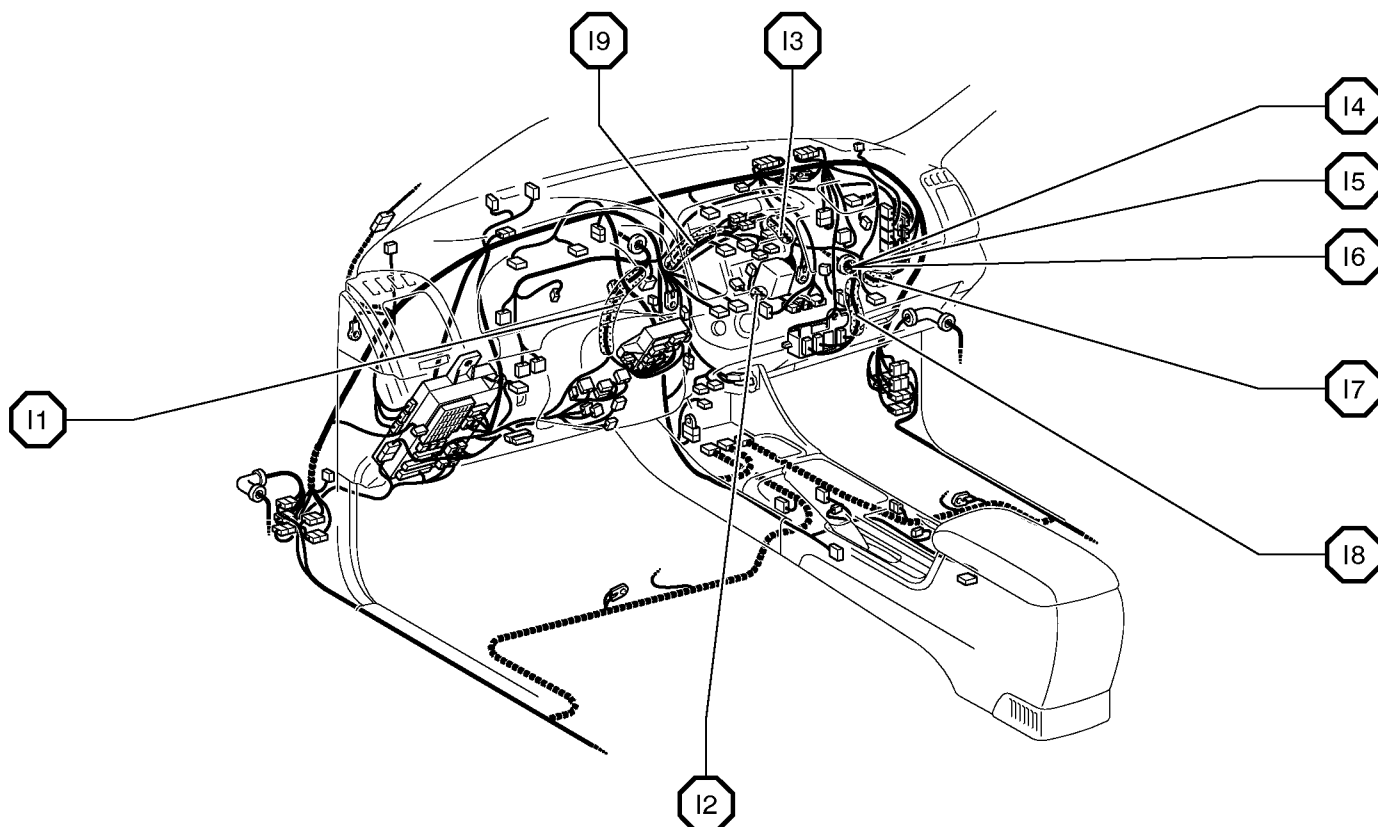

## Connector Joining Wire Harness and Wire Harness

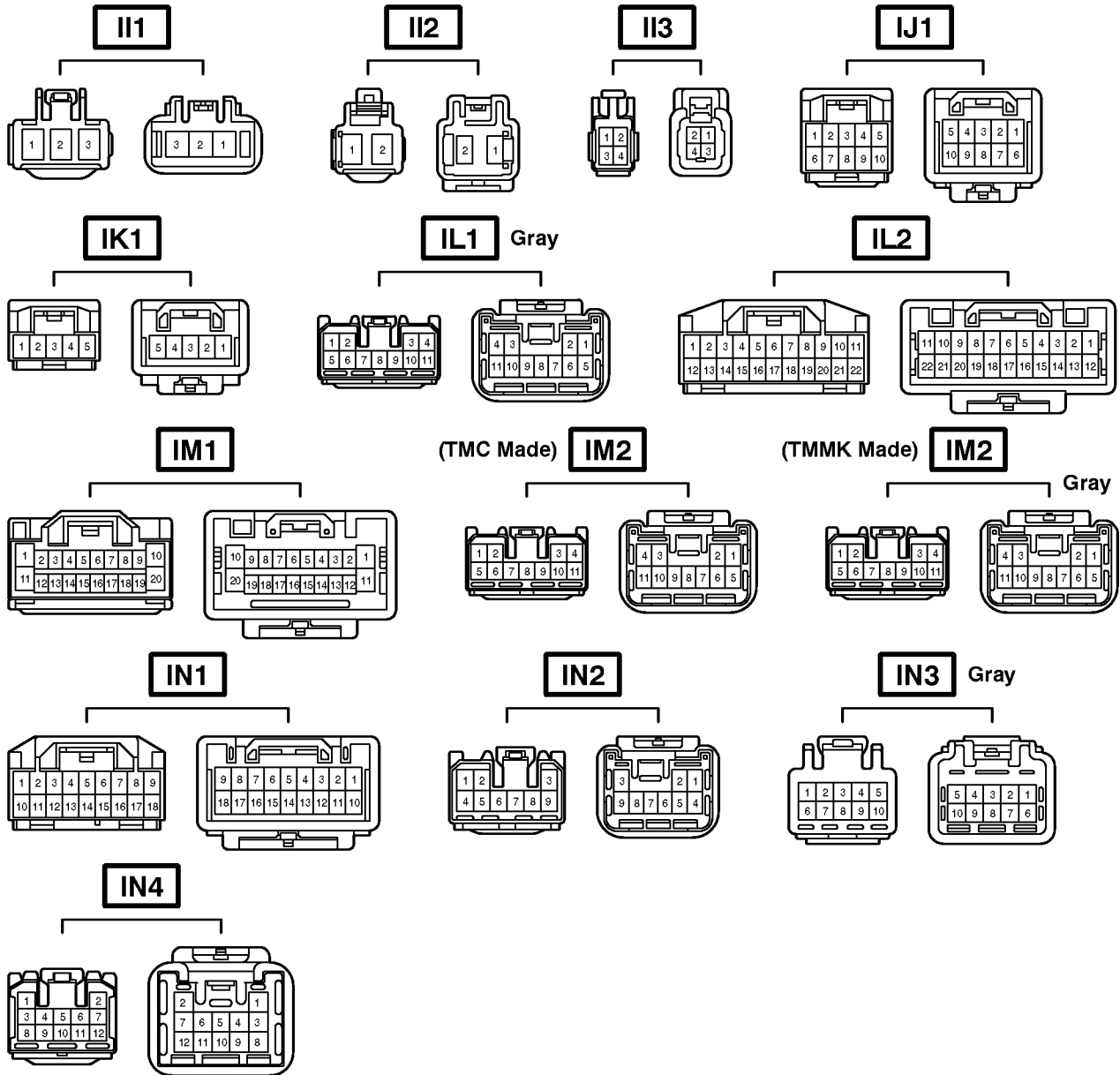

Code	Joining Wire Harness and Wire Harness (Connector Location)
II1	
II2	Instrument Panel Wire and Instrument Panel No.3 Wire (Behind the Glove Box)
II3	
IJ1	Instrument Panel Wire and Instrument Panel Wire (Instrument Panel Reinforcement RH)
IK1	Instrument Panel Wire and Instrument Panel No.3 Wire (Behind the Glove Box)
IL1	Engine Wire and Instrument Panel Wire (Behind the Glove Box)
IL2	
IM1	Front Door RH Wire and Instrument Panel Wire (Right Kick Panel)
IM2	
IN1	
IN2	
IN3	Instrument Panel Wire and Floor No.2 Wire (Right Kick Panel)
IN4	



## G ELECTRICAL WIRING ROUTING

□ : Location of Connector Joining Wire Harness and Wire Harness

▽ : Location of Ground Points

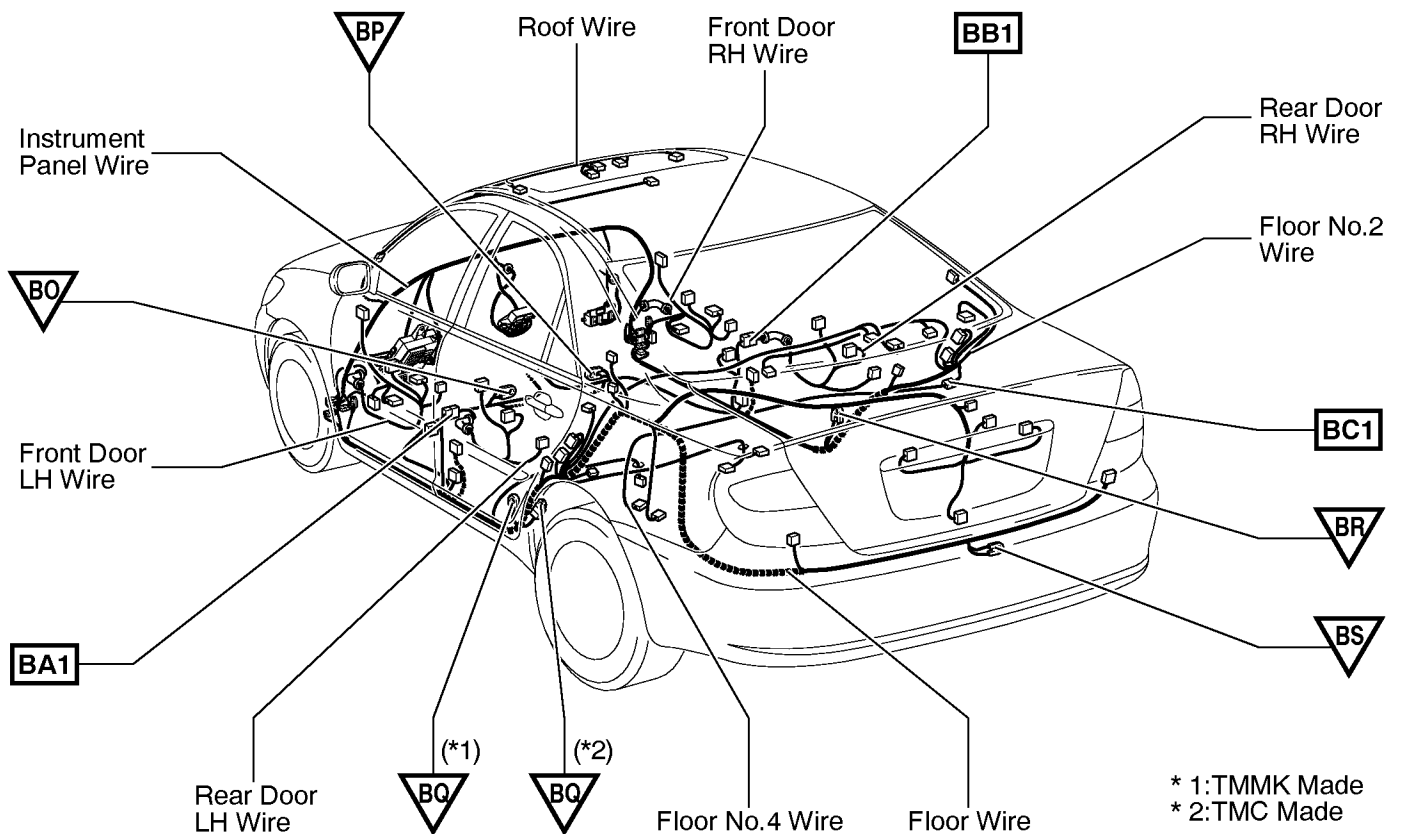

○ : Location of Splice Points

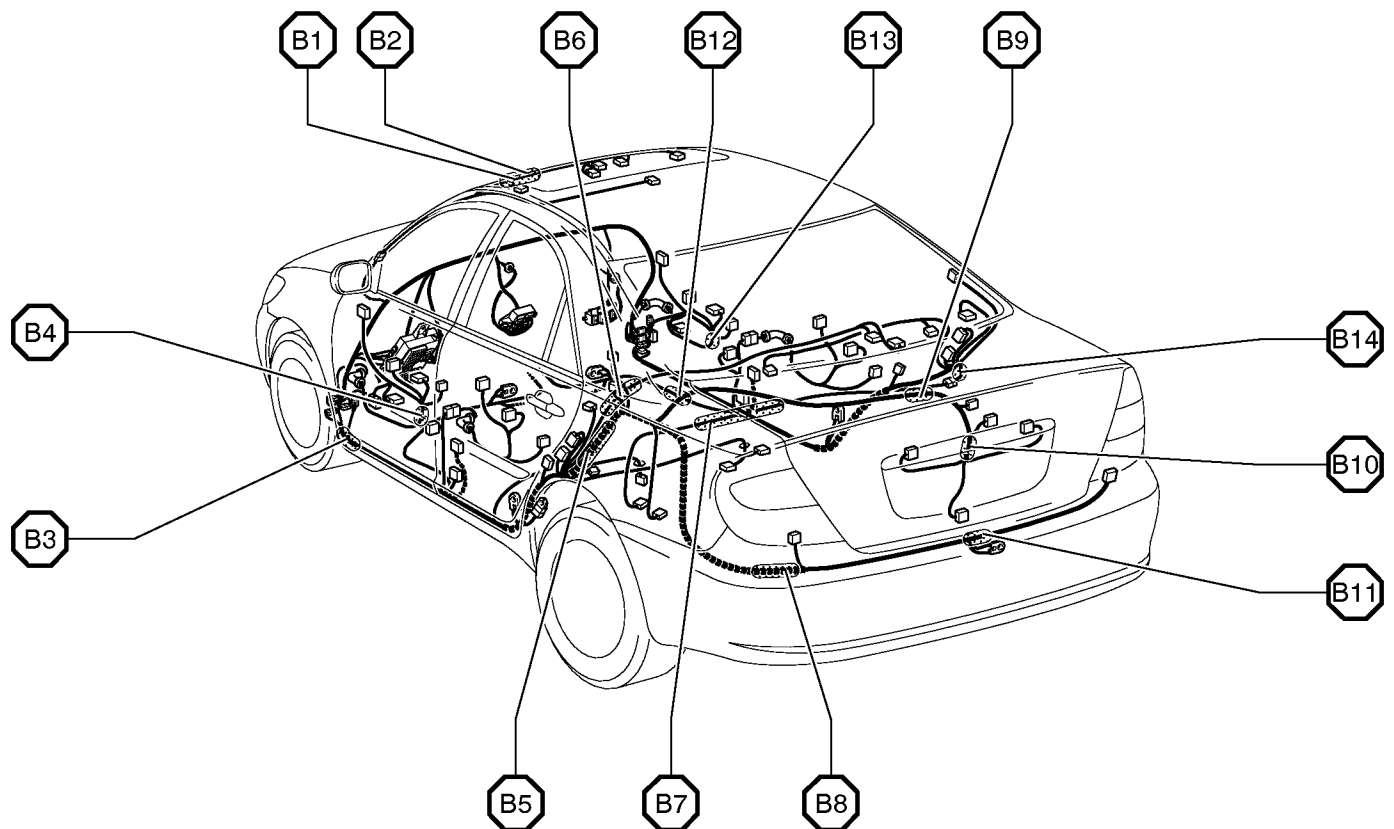

## Connector Joining Wire Harness and Wire Harness

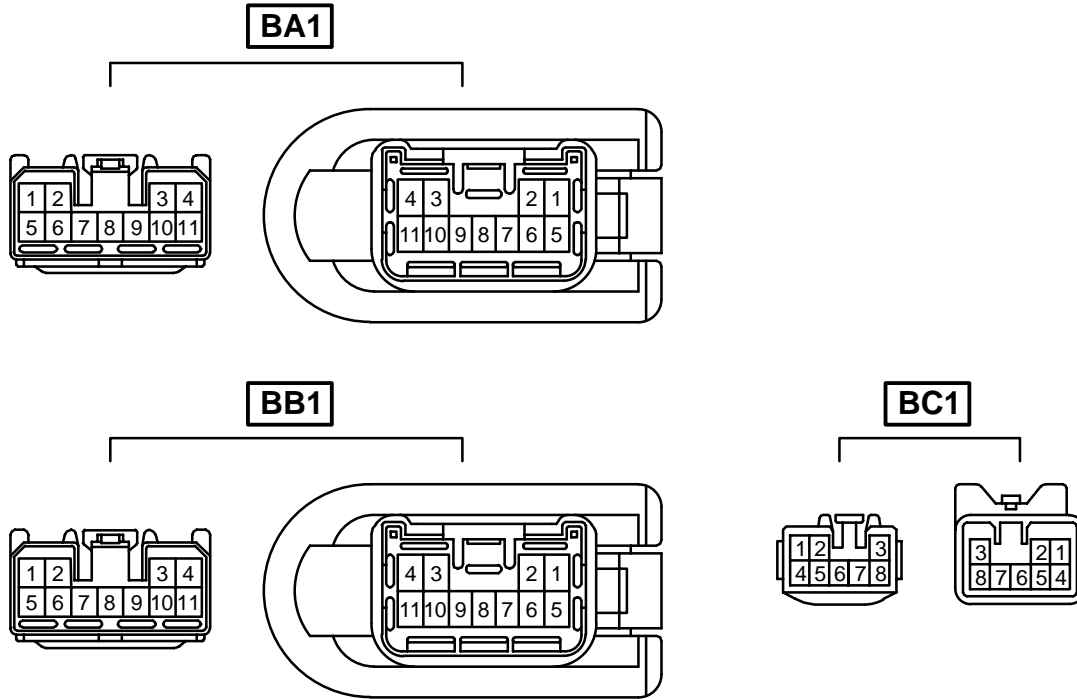

Code	Joining Wire Harness and Wire Harness (Connector Location)
BA1	Rear Door LH Wire and Floor Wire (Left Center Pillar)
BB1	Rear Door RH Wire and Floor No.2 Wire (Right Center Pillar)
BC1	Floor No.4 Wire and Floor No.2 Wire (Behind the Rear Passenger's Seat RH)

## G ELECTRICAL WIRING ROUTING

□ : Location of Connector Joining Wire Harness and Wire Harness

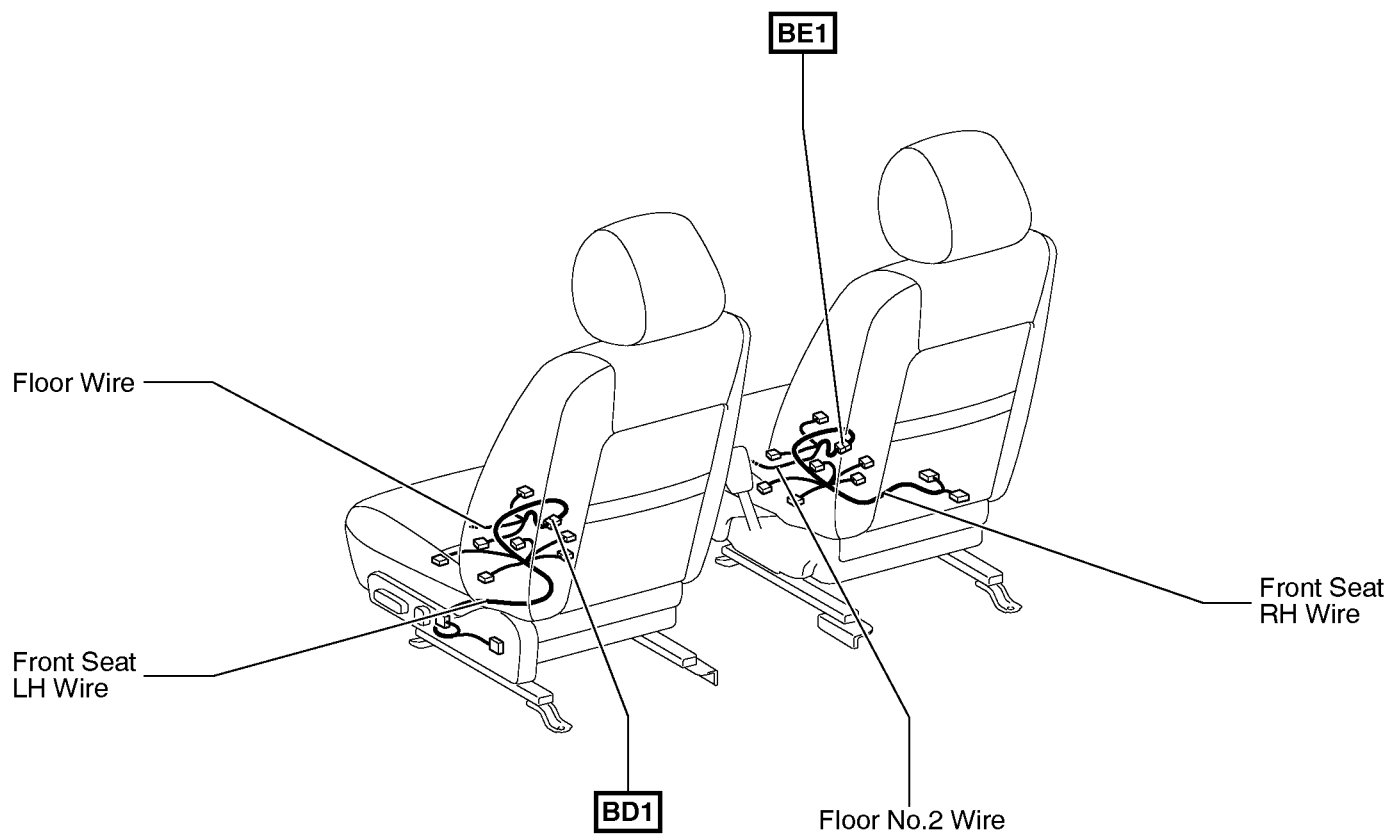

○ : Location of Splice Points

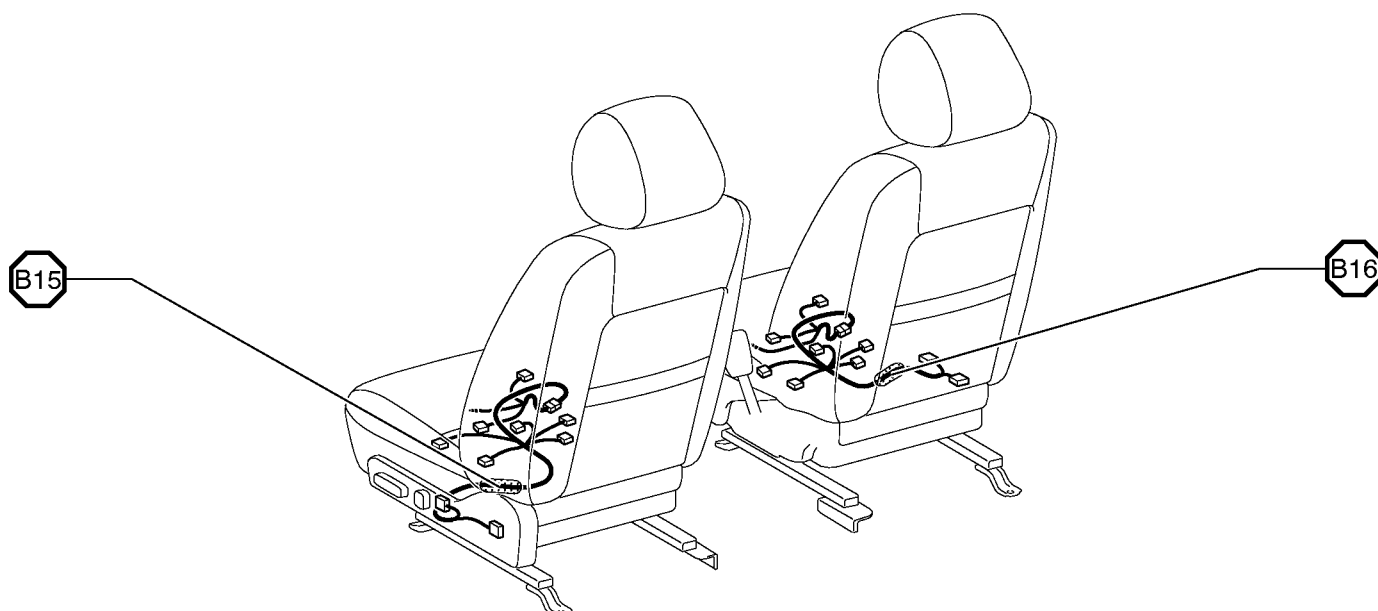

## Connector Joining Wire Harness and Wire Harness

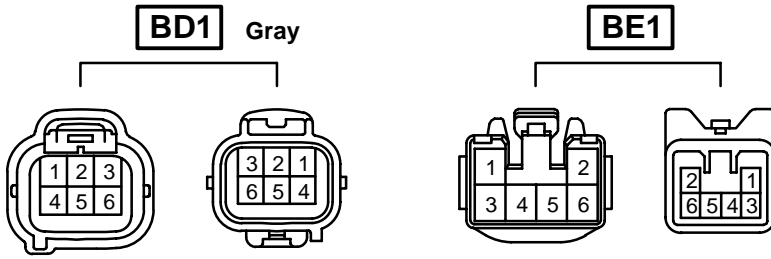

Code	Joining Wire Harness and Wire Harness (Connector Location)
BD1	Floor Wire and Front Seat LH Wire (Under the Driver's Seat)
BE1	Floor No.2 Wire and Front Seat RH Wire (Under the Front Passenger's Seat)

## HINT

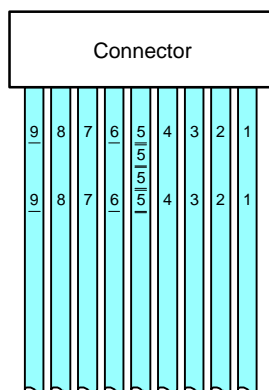

There are two types of wire harness for the instrument panel on CARMY.

Type A : The wire harness that uses the color-coded wire.

Type B : The wire harness that uses the same colored wire. (Not color-coded)

In case of using the same colored wires, each terminal number is printed on the wire as shown in the illustration on the left in order to distinguish each wiring.

Be sure to connect the terminal to the same place as indicated by the terminal number printed on the wire after disconnecting the terminal from the connector.

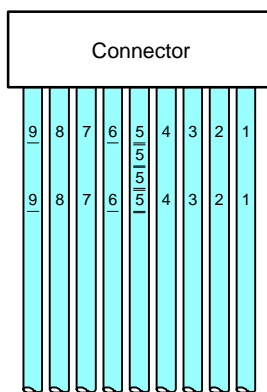

There are two types of wire harness for the instrument panel on CARMY.

Type A : The wire harness that uses the color-coded wire.

Type B : The wire harness that uses the same colored wire. (Not color-coded)

In case of using the same colored wires, each terminal number is printed on the wire as shown in the illustration on the left in order to distinguish each wiring.

Be sure to connect the terminal to the same place as indicated by the terminal number printed on the wire after disconnecting the terminal from the connector.